

# DRAWING FOR CUSTOMER

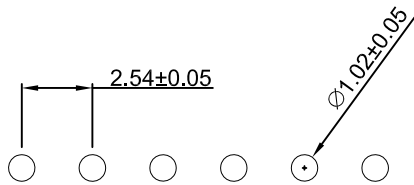

SUGGESTED PCB LAYOUT  
(COMPONENT SIDE)

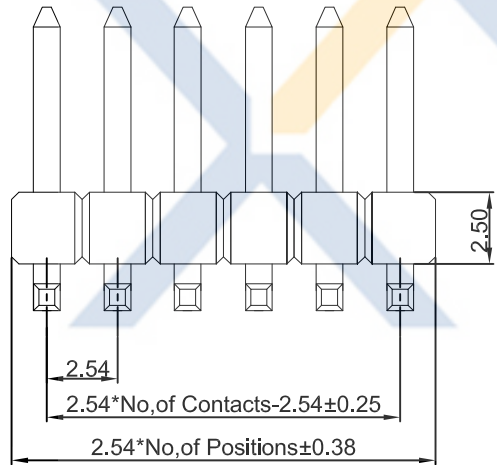
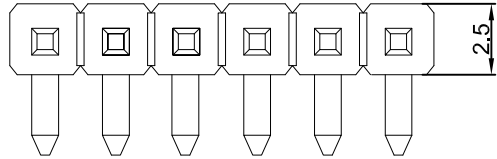
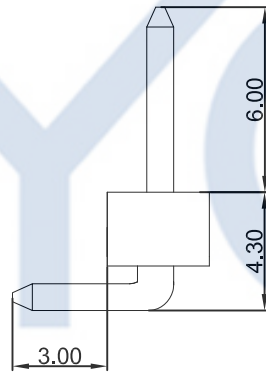

- SPEC.:
- Rated Voltage: 250V AC,DC
  - Rated Current: 3A AC,DC
  - Withstand Voltage: 800V AC/minute
  - Contact Resistance: 20mΩ max
  - Insulation Resistance: 1000MΩ min
  - Temperature Range: -25°C~+85°C

- Material :
- Insulator(A): PBT UL94V-0
  - Contact Pin(B): Brass  
Finish: Gold-Plated, over Nickel

KB951-XX X D R 3 A

Pin No.	Version
包装方式:	Mold No.
T:TUBE (管装)	R:Right Angle
R:REEL (卷装)	V:Vertical
P: PE (袋装)	S:SMT
	D:DIP

Precision Connectors

**XYCO** 东莞市轩业电子科技有限公司  
 TEL: 0769-8297 9981/2/3 <http://www.XYCO.com.cn>

2013-06-08	A		KB951-XXXDR3A	Devin	TOLERANCE 公差	DRAWING 設計者	Devin	KB951-XXXDR3A
DATE 日期	VER 版本	CHANGE HISTORY 變更歷史	CHANGED NAME 修改後料號	DRAWING 變更者	.X=±0.30 .XX=±0.20 .XXX=±0.10	CHECKED 審查	Thomas	PART NO. 料號
						APPROVED 核准	William	DWG NO. 圖號
								PE1711007A

UNIT 單位	mm	PRODUCT NAME 產品名稱	DP2.54mm DIP Right Angle Single Row Wafer
------------	----	----------------------	---