

# DRAWING FOR CUSTOMER

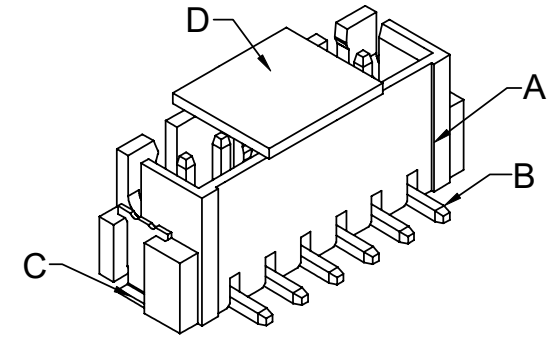
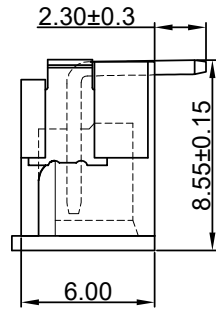
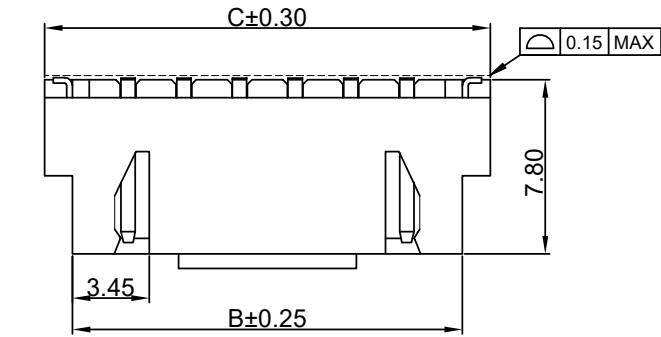

- SPEC.:
- Rated Voltage:250V AC,DC
  - Rated Current:3A AC,DC
  - Withstand Voltage:1000V AC/minute
  - Contact Resistance:20mΩ max
  - Insulation Resistance:1000MΩ min
  - Temperature Range:-25°C~+85°C

- Material:
- Insulator(A):C1-LCP UL94V-0  
Color:BGE-Beige
  - Contact Pin(B): Brass  
Finish:Tin plated;over Nickel
  - Solder Tab(C):Phosphor Bronze  
Finish:Tin plated;over Nickel
  - Cap(D):LCP UL94V-0  
Color:Beige

KB952-XX X S V 6 A-C1- BGE

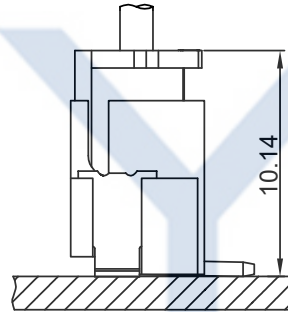
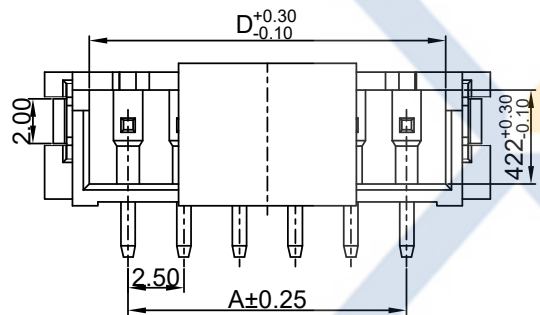
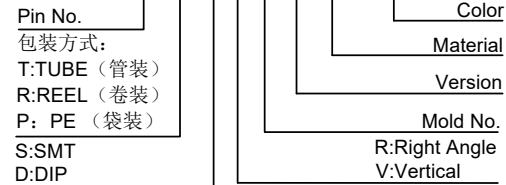

Assembly Layout

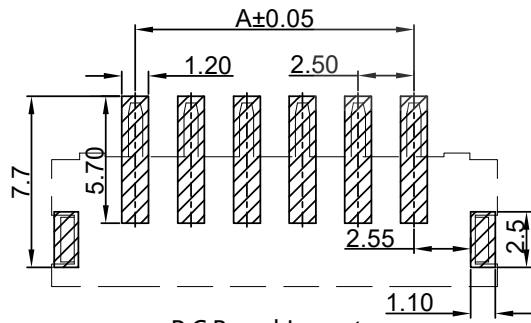

P.C.Board Layout

General Tolerance:±0.05

Poles	Dimensions (mm)			
	A	B	C	D
02	2.50	7.50	10.00	6.00
03	5.00	10.00	12.50	8.50
04	7.50	12.50	15.00	11.00
05	10.00	15.00	17.50	13.50
06	12.50	17.50	20.00	16.00
07	15.00	20.00	22.50	18.50
08	17.50	22.50	25.00	21.00
09	20.00	25.00	27.50	23.50
10	22.50	27.50	30.00	26.00
11	25.00	30.00	32.50	28.50
12	27.50	32.50	35.00	31.00
13	30.00	35.00	37.50	33.50
14	32.50	37.50	40.00	36.00
15	35.00	40.00	42.50	38.50
16	37.50	42.50	45.00	41.00

**XYCO** 东莞市轩业电子科技有限公司  
TEL: 0769-8297 9981/2/3 <http://www.XYCO.com.cn>

2016-11-22		A	KB952-XXXSV6A-C1-BGE		Devin	TOLERANCE 公差	DRAWING 設計者	Devin	KB952-XXXSV6A-C1-BGE	
DATE 日期	VER 版本	CHANGE HISTORY 變更歷史	CHANGED NAME 修改後料號	DRAWING 變更者		.X±0.30 .XX±0.20 .XXX±0.10	CHECKED 審查	Thomas	PART NO. 料號	UNIT 單位
							APPROVED 核准	William	DWG NO. 圖號	mm
									PE1905028A	PRODUCT NAME 產品名稱

XH PH2.50mm Wire To Board	
SMT Vertical Wafer	