

# DRAWING FOR CUSTOMER

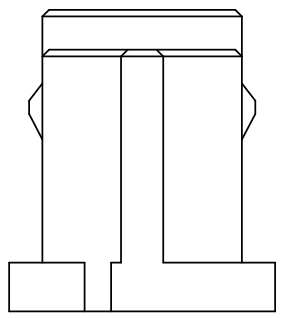
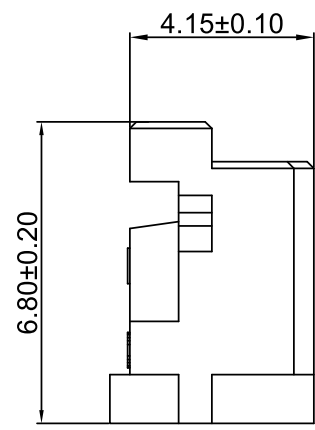
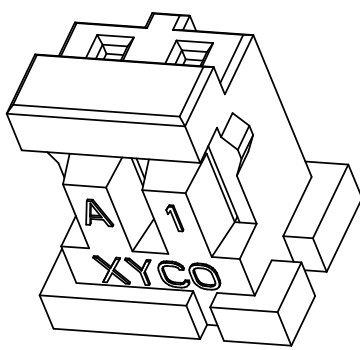
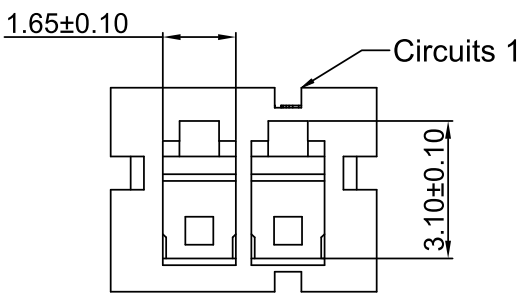
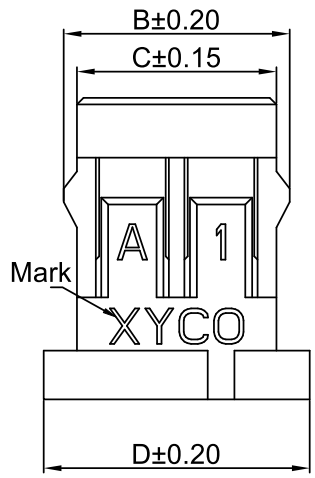
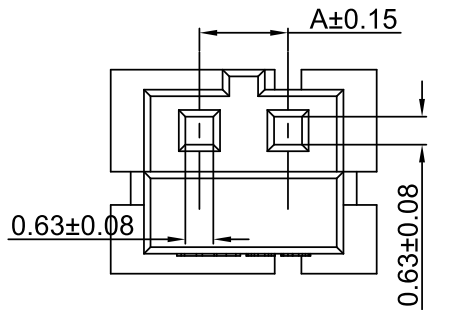

- SPEC.:
- Rated Voltage:250V AC,DC
- Rated Current:3A AC,DC
- Withstand Voltage:650V AC/minute
- Contact Resistance:30mΩ max
- Insulation Resistance:1000MΩ min
- Temperature Range:-25℃~+85℃

- Material:
- Insulator:NB1-PA66 UL94V-0 HF
- Color:BK-Black

KB930-XX H 1 A -NB1 X- BK

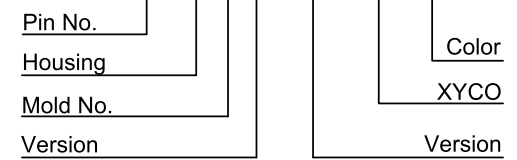

Poles	Dimensions(mm)			
	A	B	C	D
02	2.00	5.10	4.50	6.00
03	4.00	7.10	6.50	8.00
04	6.00	9.10	8.50	10.00
05	8.00	11.10	10.50	12.00
06	10.00	13.10	12.50	14.00
07	12.00	15.10	14.50	16.00
08	14.00	17.10	16.50	18.00
09	16.00	19.10	18.50	20.00
10	18.00	21.10	20.50	22.00
11	20.00	23.10	22.50	24.00
12	22.00	25.10	24.50	26.00
13	24.00	27.10	26.50	28.00
14	26.00	29.10	28.50	30.00
15	28.00	31.10	30.50	32.00



**XYCO** 东莞市轩业电子科技有限公司  
 TEL: 0769-8297 9981/2/3 <http://www.XYCO.com.cn>

2024-03-15		A	CHANGE HISTORY 變更歷史	CHANGED NAME 修改後料號	DRAWING 變更者	TOLERANCE 公差	DRAWING 製圖	KB930-XXH1A-NB1X-BK	
DATE 日期	VER 版本	DEVIN					CHECKED 審查	PART NO. 料號	UNIT 單位
						.X=±0.30 .XX=±0.20 .XXX=±0.10	APPROVED 核准	DWG NO. 圖號	PE240307A

