

DRAWING FOR CUSTOMER

■SPEC.:

- Voltage Rating:250V AC/DC
- Current Rating:2A AC/DC
- Dielectric Strength :500V AC/minute
- Contact Resistance:20mΩ max
- Insulation Resistance:1000MΩ min
- Temperature Range:-25°C to+85°C

■Terminal:

- Material:Phosphor Bronze/Brass
- Finish:Gold/Tin-Plated,Over Nickel
- Applicable Wire:AWG#26~30
- QTY.:15KPCS/Reel

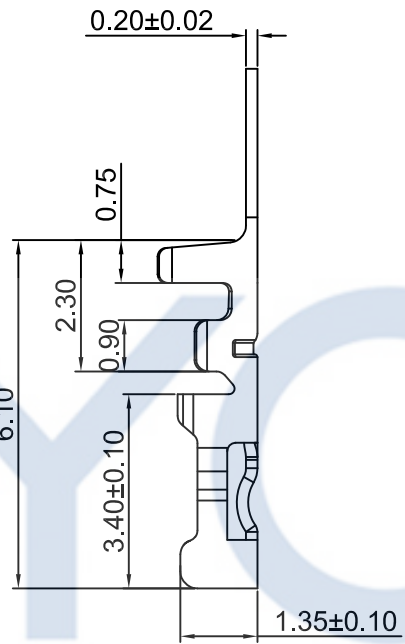
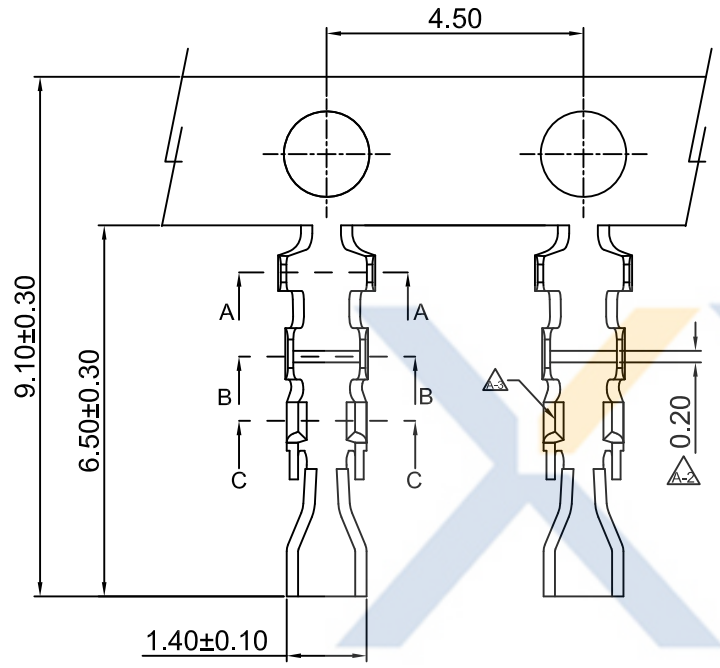

KB931-XXTP1A

1:All plated
2:Half plated

0: Tin-plat
1: Gold Plat 1u"
2: Gold Plat 3u"
3: Gold Plat 5u"
15: Gold Plat 15u"

Version

Mold No.

Phosphor

Terminal

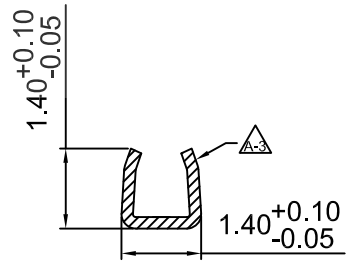
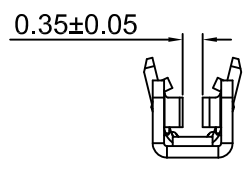

Section:C-C

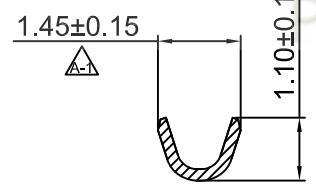

Section:B-B

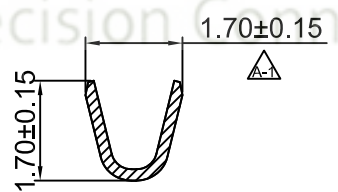

Section:A-A

2021-09-10	A-3	端子优化	KB931-XXTP1A	Devin
2020-09-15	A-2	中铆脚位置增加加强筋	KB931-XXTP1A	Devin
2020-05-05	A-1	铆脚位置调整	KB931-XXTP1A	Devin
2014-10-16	A		KB931-XXTP1A	Devin
DATE 日期	VER 版本	CHANGE HISTORY 變更歷史	CHANGED NAME 修改後料號	DRAWING 變更者

TOLERANCE 公差	DRAWING 設計者	Devin	KB931-XXTP1A	
.X=±0.30 .XX=±0.20 .XXX=±0.10	CHECKED 審查	Thomas	PART NO. 料號	
	APPROVED 核准	William	DWG NO. 圖號	PE3503A

XYCO 东莞市轩业电子科技有限公司
TEL: 0769-8297 9981/2/3 http://www.XYCO.com.cn

UNIT 單位	mm	PRODUCT NAME 產品名稱	DP2.0mm Wire To Board Terminal
------------	----	----------------------	-----------------------------------