

DRAWING FOR CUSTOMER

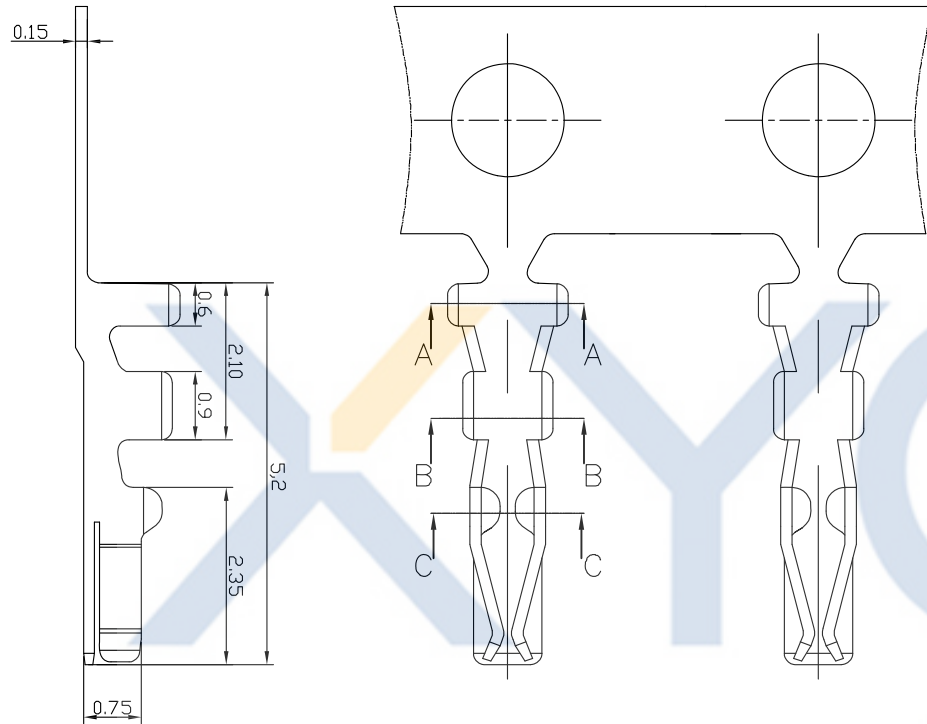

- SPEC.:
- Rated Voltage:150V AC,DC
 - Rated Current:1A AC,DC
 - Withstand Voltage:500V AC/minute
 - Contact Resistance:30mΩ max
 - Insulation Resistance:100MΩ min
 - Temperature Range:-40℃~+85℃
 - Applicable wire:AWG#28~32

- Terminal
- Material: Phosphor Bronze C5191
 - Finish: Tin-plated, over Nickel
 - QTY.:15KPCS/Reel

KB913-XXXT4A

- 1:All plated
- 2:Half plated

Plating

- 0: Tin-plated
- 1: Gold Plated1u"
- 2: Gold Plated3u"
- 3: Gold Plated5u"

Version

Mold No.

Terminal

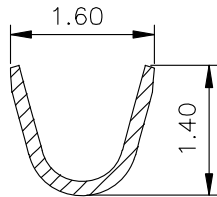

SECTION:A-A

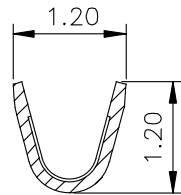

SECTION:B-B

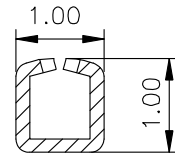

SECTION:C-C

XYCO PRECISION CONNECTORS

TEL: 0769-8297 9981/2/3 <http://www.XYCO.com.cn>

				TOLERANCE 公差		DRAWING 設計者		John		KB913-1XT4A					
2013-08-16		A		KB913-1XT4A		John				PART NO. 料號		UNIT 單位		mm	
DATE 日期		VER 版本		CHANGE HISTORY 變更歷史		CHANGED NAME 修改後料號		DRAWING 變更者		DWG NO. 圖號		PE3001A		PRODUCT NAME 產品名稱	
						.X=±0.30 .XX=±0.20 .XXX=±0.10		CHECKED 審查		Thomas				FI-S PH1.25mm Terminal	
						APPROVED 核准		William							